

NOTE E MATERIALI
 Per note e materiali vedere box. 10075

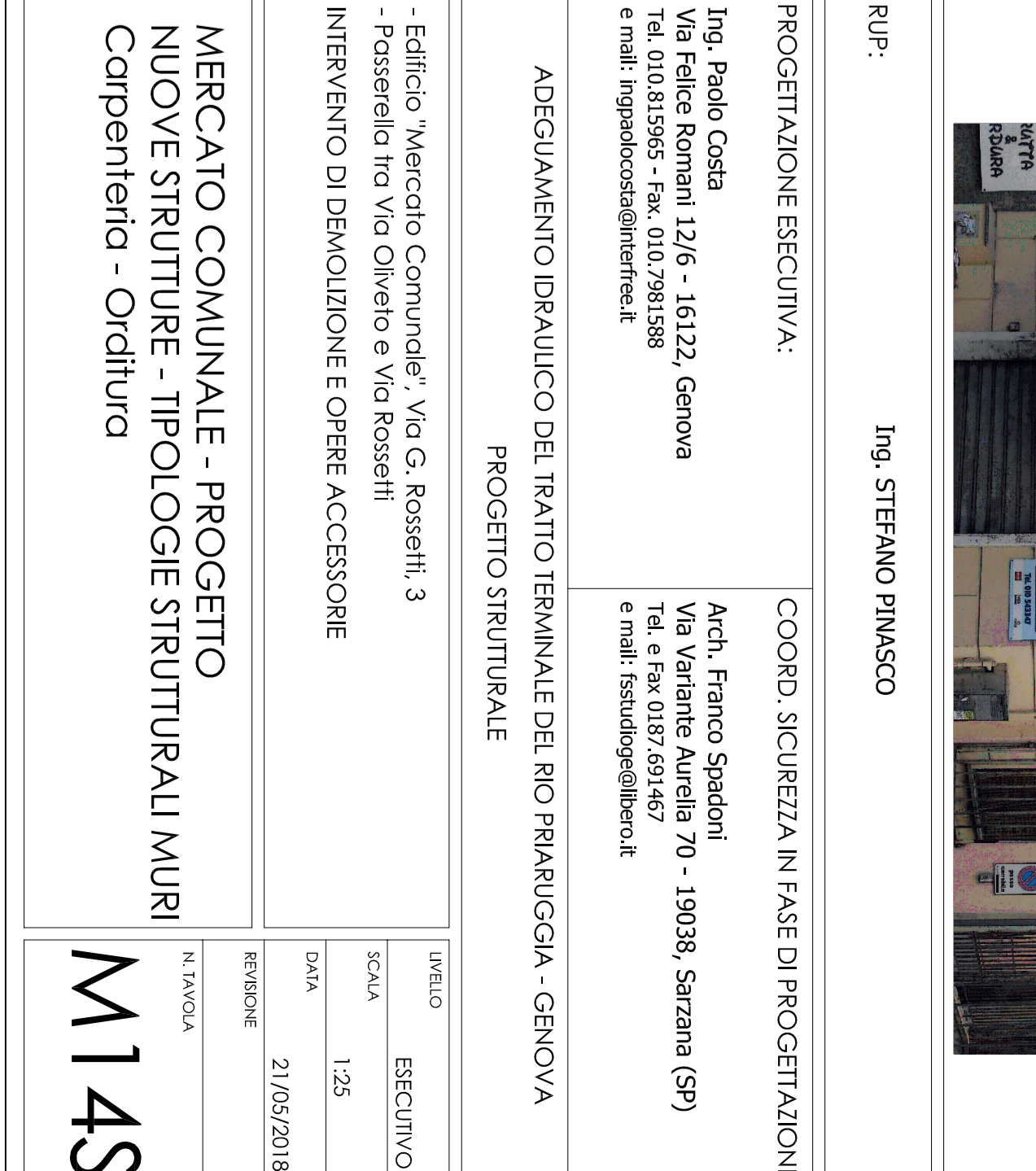
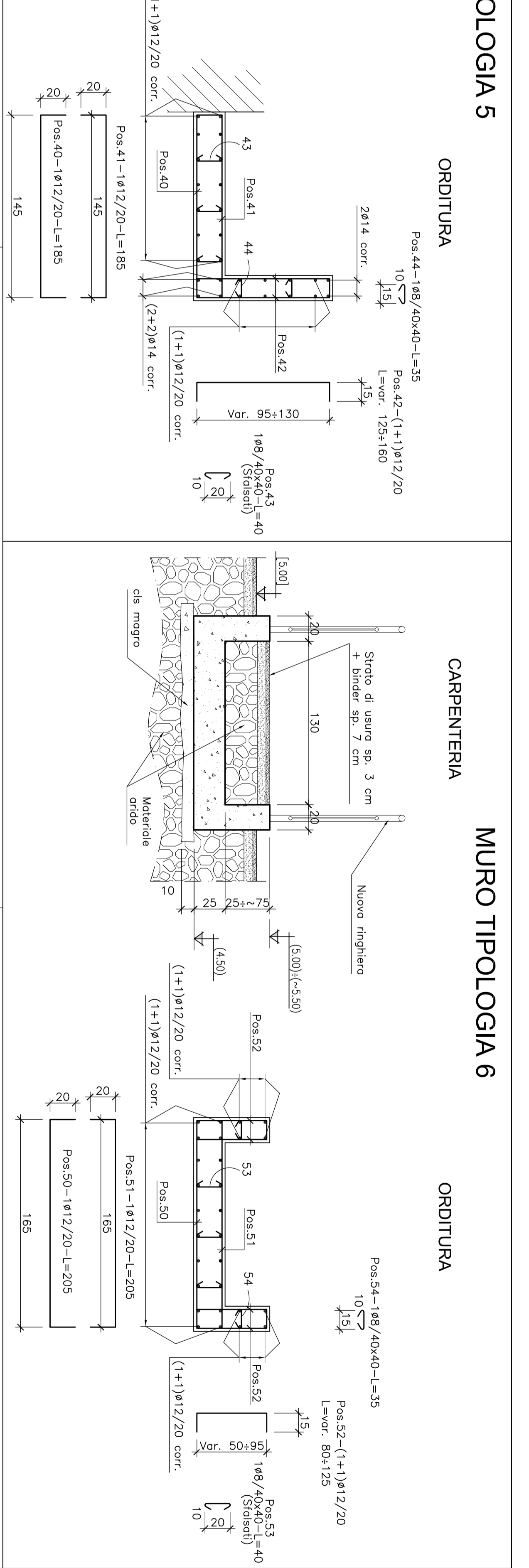
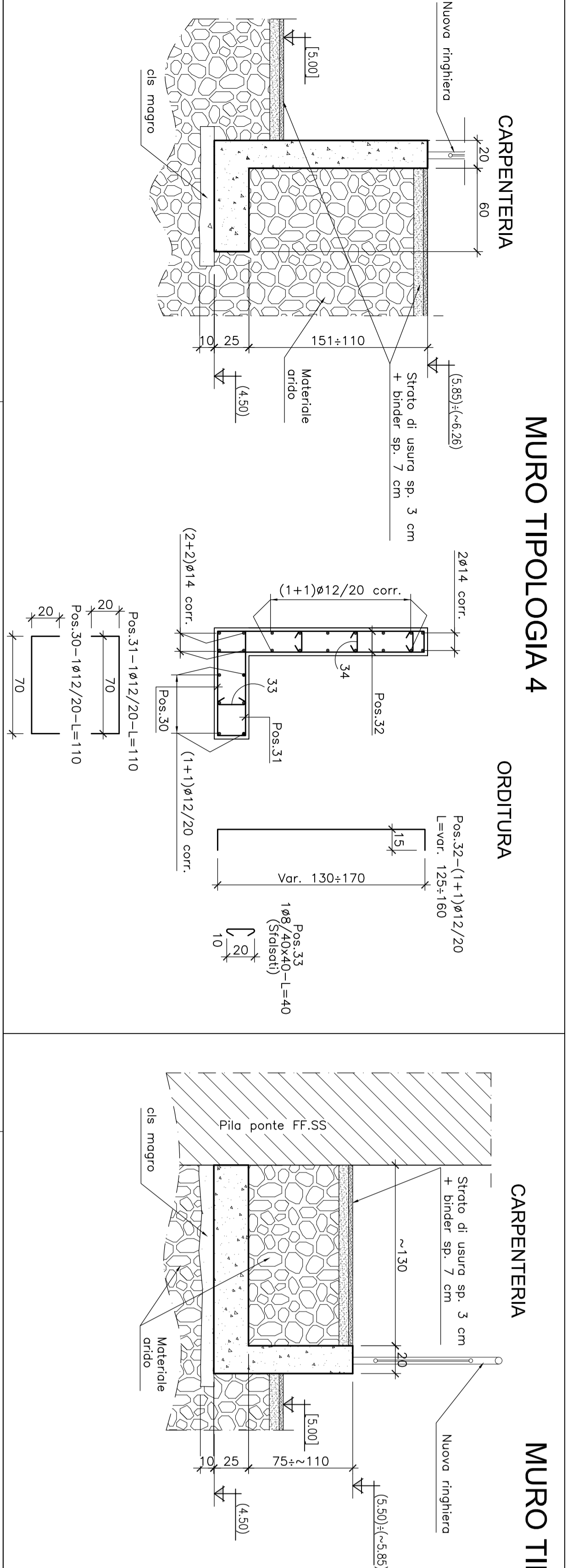
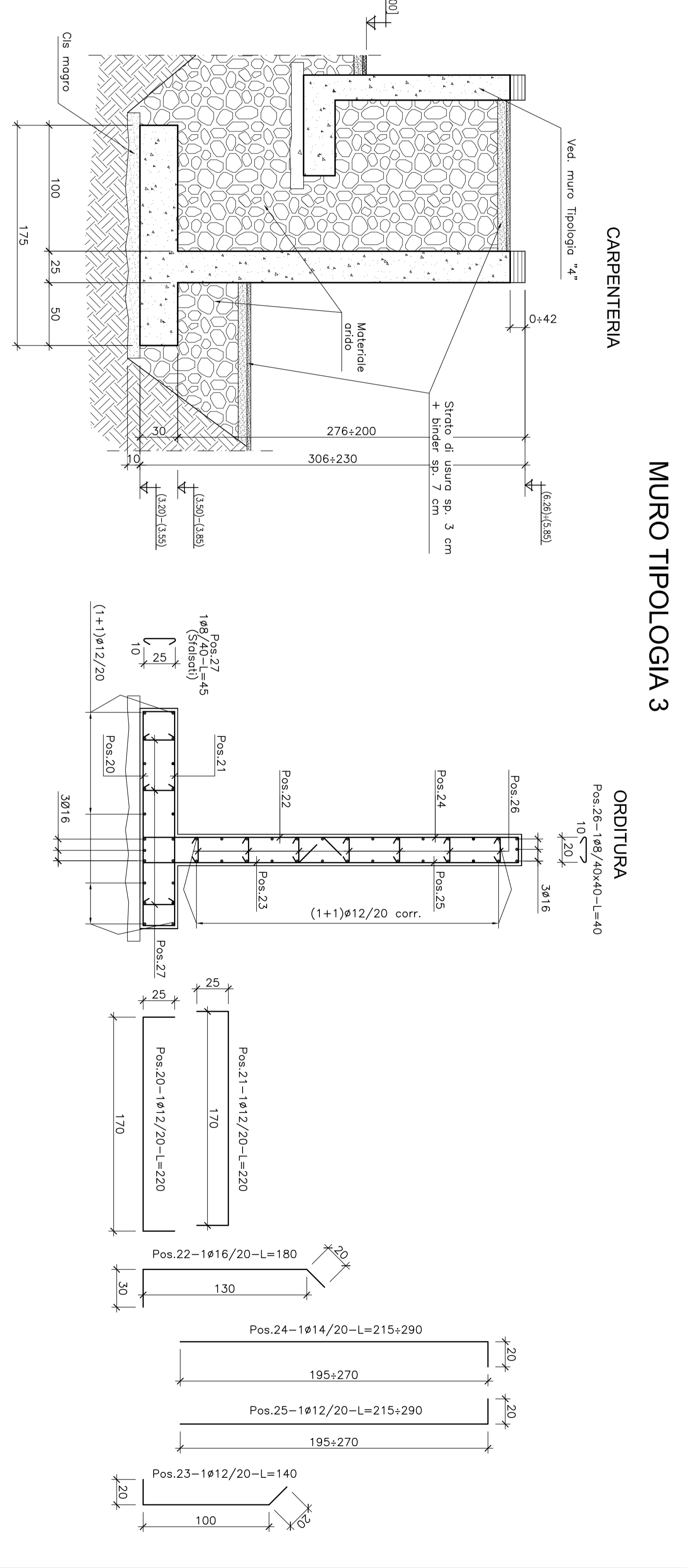
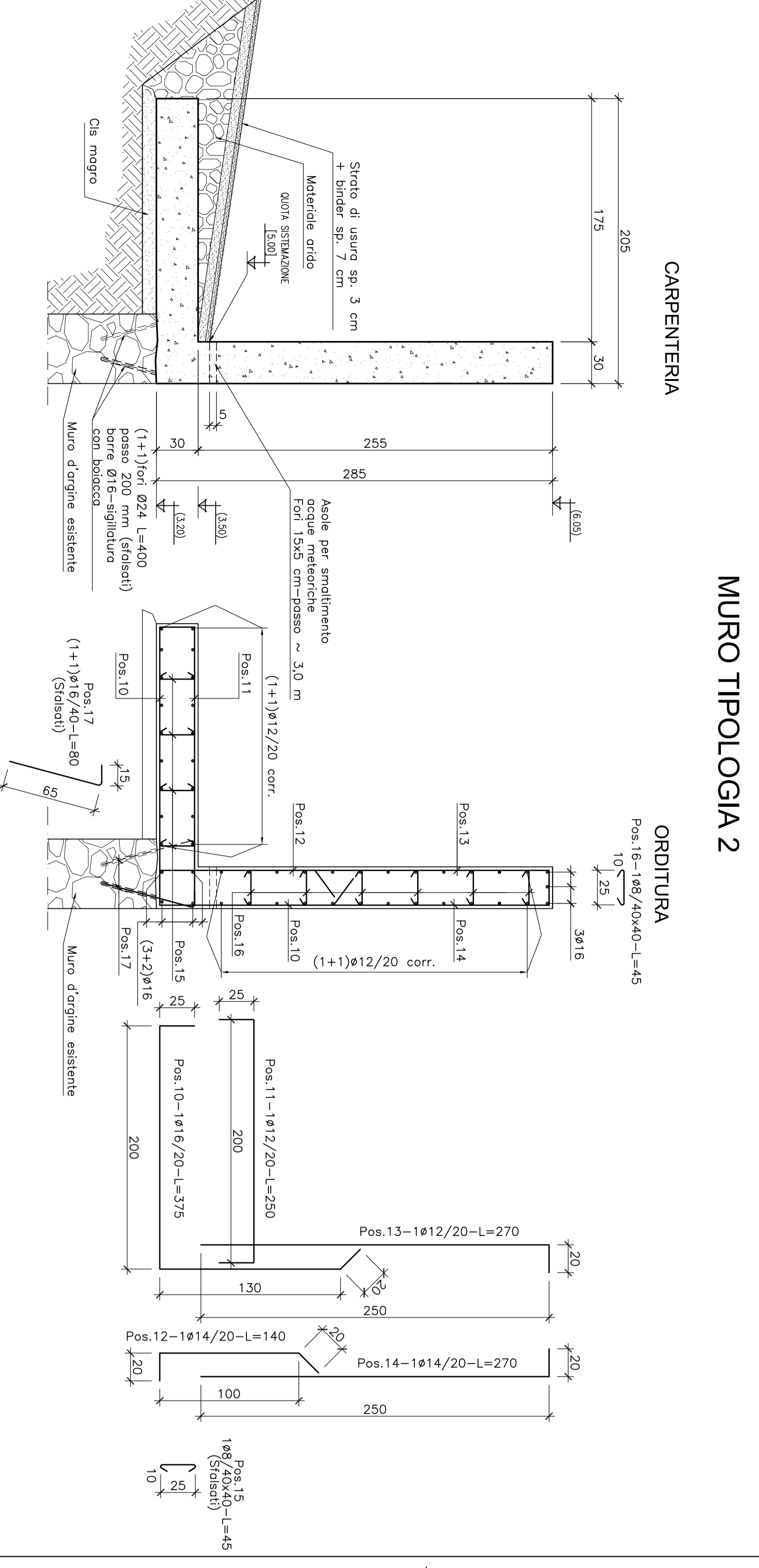
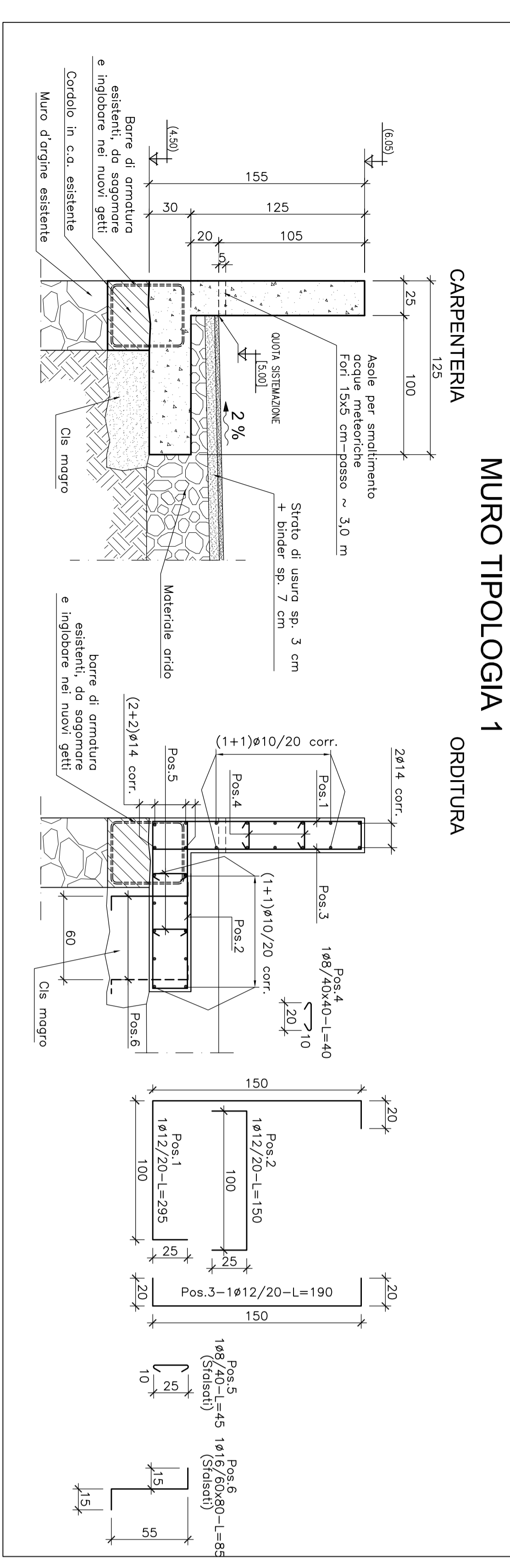

PROGETTAZIONE ESECUTIVA:
 Ing. Paolo Costa
 Via Felice Romari 12/6 - 16122, Genova
 Tel. 010.815955 - Fax. 010.798158
 e-mail: ingpaolocosta@tin.it

COORD. SICUREZZA IN FASE DI PROGETTAZIONE:
 Arch. Franco Spadoni
 Via Variante Aurelia 70 - 19038, Sarzana (SP)
 Tel. & Fax 0187.691467
 e-mail: franspadoni@tin.it

PROGETTO STRUTTURALE:
 ING. STEFANO PIVASSO

PROGETTO STRUTTURALE DEL NO. PRIBARUGIGA - GENOVA

MERCATO COMUNALE - PROGETTO NUOVE STRUTTURE - TIPOLOGIE STRUTTURALI MURI Carpentaria - Orditura

SCALE: 1:25
 DATA: 21/05/2018
 N. INVARIA: M14S

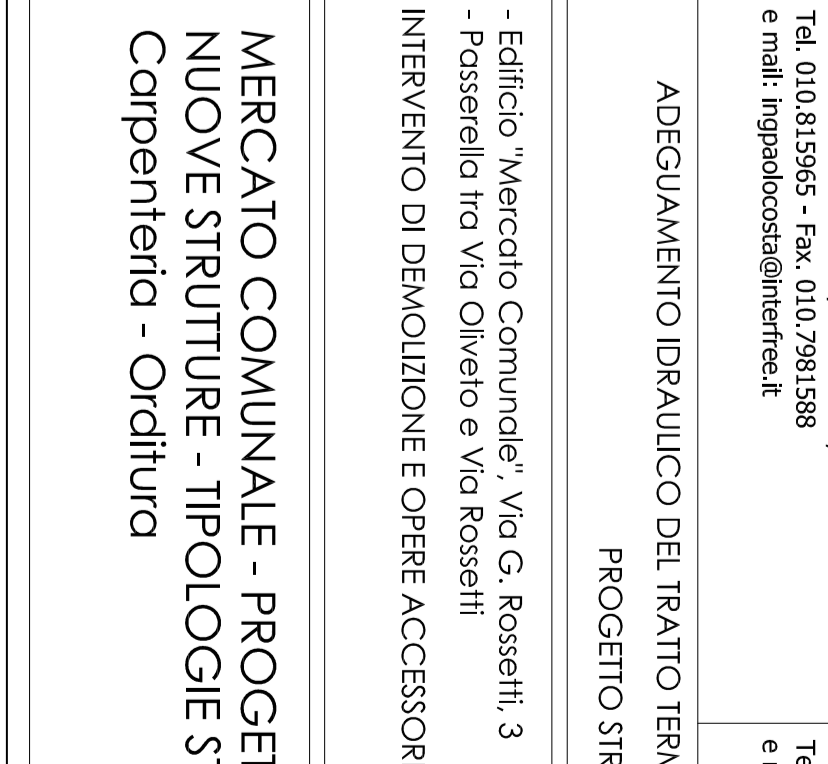

COMUNE DI GENOVA
 AREA TECNICA
 DIREZIONE OPERE IDRAULICHE E SANITARIE